

This custom kit is manufactured by Snowbear Company to fit:
FORD F150 PICKUP MOUNT ASSEMBLY
(2 x 4) YEAR 1997 and 2003

This custom kit is manufactured by Snowbear Company to fit:
FORD F250 LIGHT DUTY
New Body Style MOUNT ASSEMBLY
(2 x 4) YEAR 1997 to 1999

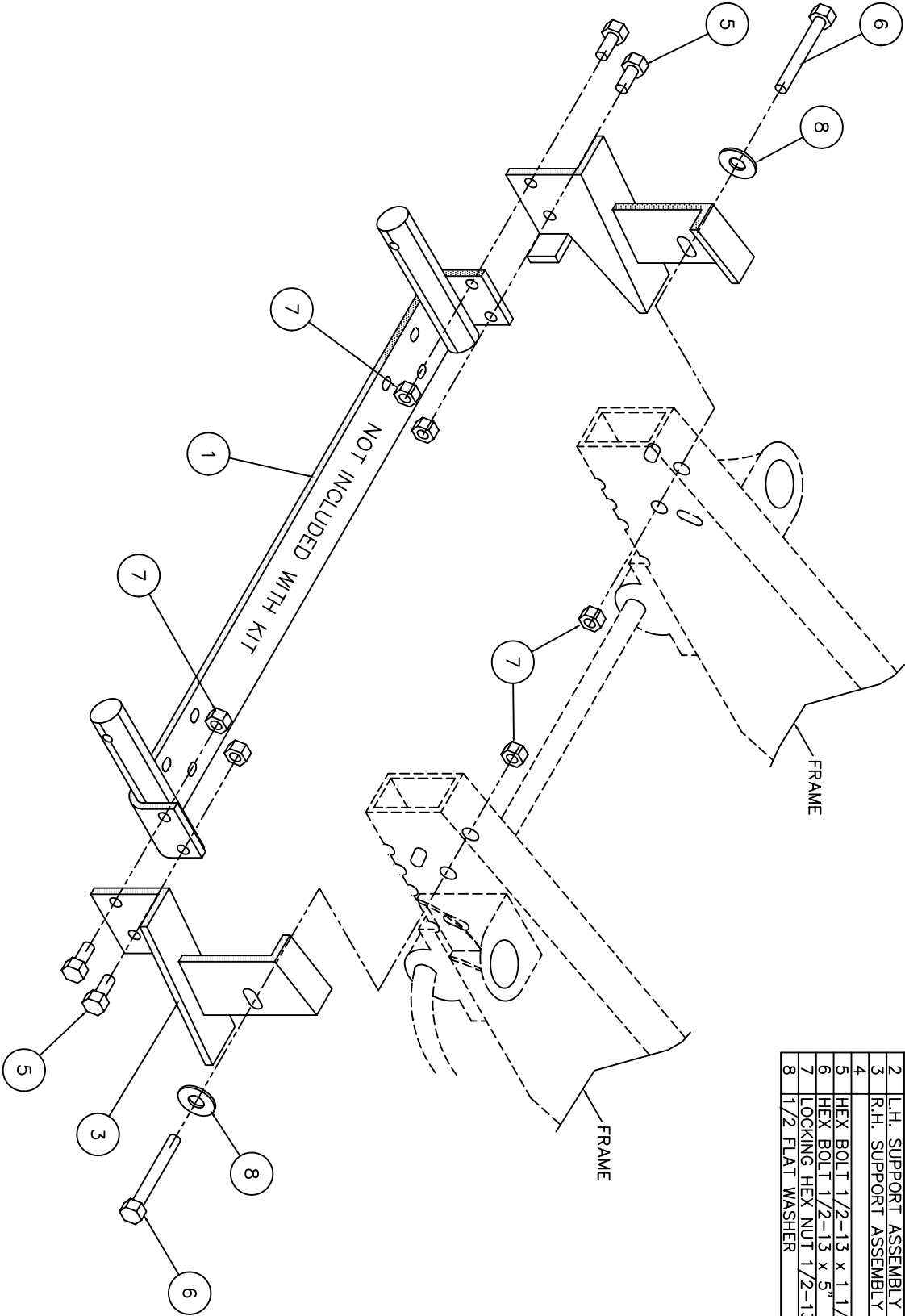

ITEM	DESCRIPTION	PART #	QTY.
* 1	CROSS MEMBER	5XM5	1
* NOT INCLUDED IN KIT, PURCHASE SEPARATELY			
2	L.H. SUPPORT ASSEMBLY	51511L	1
3	R.H. SUPPORT ASSEMBLY	51511R	1
4	HEX BOLT 1/2-13 x 1 1/2	72510	4
5	HEX BOLT 1/2-13 x 5"	72545	2
6	LOCKING HEX NUT 1/2-13	72595	6
7	1/2 FLAT WASHER	72580	2